

James Keane  
 Proposed Manure Pit  
 OS XXVII 4/8  
 Newbrook TID  
 Kildare P.O.  
 Co Leinm.  
 OST 1217684.

END ELEVATION.

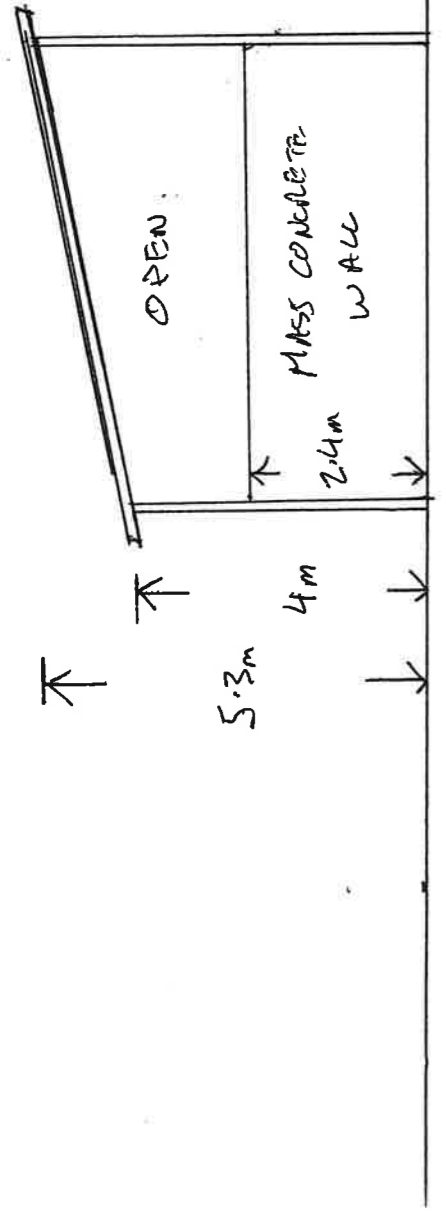

PLAN.

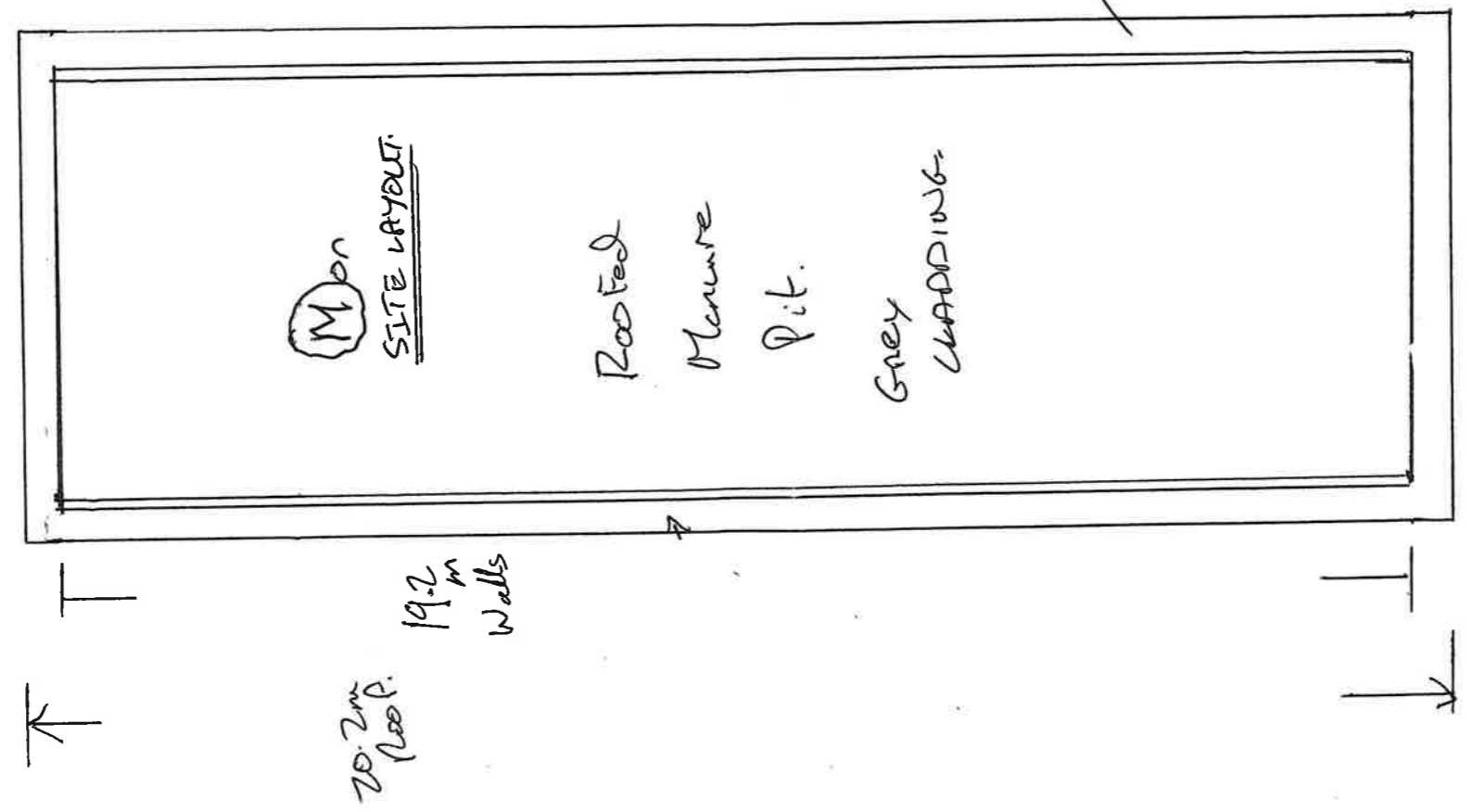

Roof Overhang 0.5m.  
 on all 4 sides  
 of manure pit.

PLANNING SECTION  
 LEITRIM COUNTY COUNCIL  
 26 FEB 2026  
 REF.P. FD-26-09

Drawn prepared by  
 James Keane  
 Ballinacorney  
 Leinm P.O.  
 Carr-Shannon  
 Co Leinm  
 OST 1217684.